

Thrust Ball
Bearing
51400 thrust
ball
bearing-51412

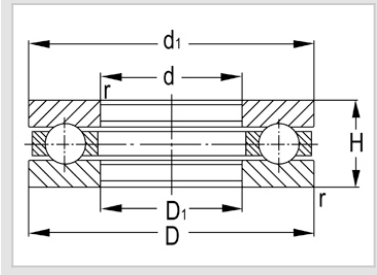

WUXI GUANGQIANG BEARING TRADE CO.,LTD



| | |
|--------------------------|--------------|
| Designation | 51412 |
| Principal Dimensions(mm) | |
| d | 60 |
| D | 130 |
| T | 51 |
| Basic Load Ratings(KN) | |
| Dynamic(Cr) | 200 |
| Static(Cor) | 395 |
| Limited Speed(rpm) | |
| Grease | 1000 |
| Oil | 1600 |
| Weight | |
| (kg) | 3.08 |

GQZ bearings wholesale high quality 51400 Thrust Ball Bearing

The 51400 bearings contain models such as 51400, 51405 and 51412.

51400 bearings are a kind of thrust ball bearings, whose specific parameters and specifications may vary from one manufacturer to another. 51405 bearings are NACHI brand products, belonging to the series of thrust ball bearings with specific dimensional parameters, such as inner diameter of 25mm, outer diameter of 60mm and thickness of 24mm. The 51412 bearing, as part of the 51400 series, has dimensional specifications such as a diameter of 60 mm, an outside diameter of 130 mm and a thickness of 51 mm. In addition, it has performance parameters such as basic load ratings and speed ratings, such as a dynamic load of 200 kN, a static load of 395 kN and, under grease lubrication and oil lubrication conditions, a The rated speeds are 1000rpm and 1600rpm under grease and oil lubrication respectively. different models are suitable for different application scenarios, and choosing the right bearing model is crucial to ensure the performance and life of the machinery and equipment.







Wuxi Guangqiang Bearing Trade Co.,Ltd-Tel:86-510-82601571-
Email:qq@gqbearing.com,shary@gqbearing.com-http://www.bearing-asia.com