

32300 Tapered Roller Bearing

Single Row Tapered Roller Bearing 32300 Tapered Roller Bearing

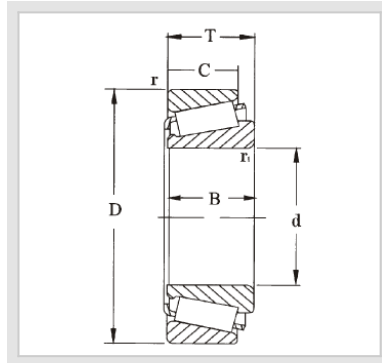

WUXI GUANGQIANG BEARING TRADE CO.,LTD



Designation	Principal dimensions [mm]			Basic load ratings [kN]		Speed ratings [rpm]		Weight (Kg)	ISO335 Dimensions (ABMA)	Dimensions [mm]						Abutment and fillet dimensions [mm]								Value					
	d1	D	B	dy(Cr)	stc(Cor)	Pu	Speed Ratings			Limiting Speed	d	d1	B	C	r1,2(min)	r3,4(min)	a	da(max)	db(min)	Da(min)	Da(max)	Db(min)	Ca(min)	Cb(min)	ra(max)	rb(max)	e	Y	Yo
	32303J2/Q	17	47	20.25	40	33.5	3.65			12000	16000	0.17	2FD	17	30.7	19	16	1	1	12	24	23	39	41	43	3	4	1	1
32304J2/Q	20	52	22.25	51	45.5	5	12000	14000	0.23	2FD	20	34.5	21	18	1.5	1.5	14	27	27	43	45	47	3	4	1.5	1.5	0.3	2	1.1
32305J2	25	62	25.25	60.5	63	7.1	8000	12000	0.36	2FD	25	41.7	24	20	1.5	1.5	15	33	32	52	55	57	3	5	1.5	1.5	0.3	2	1.1
32306J2/Q	30	72	28.75	88	85	9.65	7500	10000	0.55	2FD	30	48.7	27	23	1.5	1.5	18	39	37	59	65	66	3	5.5	1.5	1.5	0.31	1.9	1.1
32307J2/Q	35	80	32.75	95.2	106	12.2	6700	9000	0.73	2FE	35	54.8	31	25	2	1.5	20	44	44	66	71	74	4	7.5	2	1.5	0.31	1.9	1.1
32307BJ2/Q	35	80	32.75	93.5	114	13.2	6300	8500	0.80	5FE	35	59.3	31	25	2	1.5	24	42	44	61	71	76	4	7.5	2	1.5	0.54	1.1	0.6
32307(37BJ2/Q	37	80	32.75	93.5	114	13.2	6300	8500	0.85	-	37	54.8	31	25	2	1.5	20	44	44	66	71	74	4	7.5	2	1.5	0.54	1.1	0.6
32308J2/Q	40	90	35.25	117	140	16	5300	8000	1.00	2FD	40	62.9	33	27	2	1.5	23	51	49	73	81	82	3	8	2	1.5	0.35	1.7	0.9
32309J2/Q	45	100	38.25	140	170	20.4	4800	7000	1.35	2FD	45	70.4	36	30	2	1.5	25	57	53	82	91	93	4	8	2	1.5	0.35	1.7	0.9
32309BJ2/QCL7C	45	100	38.25	156	176	20	5000	6700	1.45	SFD	45	74.8	36	30	2	1.5	30	55	53	76	91	94	5	8	2	1.5	0.54	1.1	0.6
32310J2/Q	50	110	42.25	172	212	24	4300	6300	1.80	2FD	50	77.7	40	33	2.5	2	27	63	60	90	100	102	5	9	2	2	0.35	1.7	0.9
32310TN9	50	110	42.25	172	212	24	4300	6300	1.80	2FD	50	77.7	40	33	2.5	2	27	63	60	90	100	102	5	9	2	2	0.35	1.7	0.9
32310BJ2/QCL7C	50	110	42.25	183	216	24.5	4500	6000	1.85	SFD	50	82.9	40	33	2.5	2	34	62	60	83	100	103	5	9	2	2	0.54	1.1	0.6
32311J2	55	120	45.5	198	250	28.5	4000	5600	2.30	2FD	55	84.6	43	35	2.5	2	29	68	65	99	112	111	5	10.5	2	2	0.35	1.7	0.9
32311BJ2/QCL7C	55	120	45.5	216	260	30	4300	5600	2.50	SFD	55	90.5	43	35	2.5	2	36	67	65	91	112	112	5	10.5	2	2	0.54	1.1	0.6
32312J2/Q	60	130	48.5	229	290	34	3600	5300	2.85	2FD	60	91.7	46	37	3	2.5	31	74	72	107	118	120	6	11.5	2.5	2	0.35	1.7	0.9
32312BJ2/QCL7C	60	130	48.5	255	305	35.5	3800	5000	2.80	SFD	60	98.1	46	37	3	2.5	38	73	72	99	118	122	6	11.5	2.5	2	0.54	1.1	0.6
32313J2/Q	65	140	51	264	335	40	3400	4800	3.45	2GD	65	99.2	48	39	3	2.5	33	80	77	117	128	130	6	12	2.5	2	0.35	1.7	0.9
32313BJ2/QCL7CVCQ267	65	140	51	285	345	40.5	3600	4800	3.35	SGD	65	105	48	39	3	2.5	41	79	77	107	128	131	6	12	2.5	2	0.54	1.1	0.6
32314J2/Q	70	150	54	297	380	45	3200	4500	4.30	2GD	70	106	51	42	3	2.5	36	86	82	125	138	140	6	12	2.5	2	0.35	1.7	0.9
32314BJ2/QCL7C	70	150	54	325	400	46.5	3400	4300	4.25	SGD	70	113	51	42	3	2.5	44	85	82	115	138	141	7	12	2.5	2	0.54	1.1	0.6
32315J2	75	160	58	336	440	51	3000	4300	5.20	2GD	75	113	55	45	3	2.5	38	92	87	133	148	149	7	13	2.5	2	0.35	1.7	0.9
32315BJ2/QCL7C	75	160	58	380	475	55	3200	4000	5.55	SGD	75	120	55	45	3	2.5	46	90	87	124	148	151	7	13	2.5	2	0.54	1.1	0.6
32316J2	80	170	61.5	380	500	57	3000	4300	6.20	2GD	80	120	58	48	3	2.5	41	98	92	142	158	159	7	13.5	2.5	2	0.35	1.7	0.9
32317J2	85	180	63.5	402	530	60	2800	4000	6.85	2GD	85	126	60	49	4	3	42	103	99	150	166	167	7	14.5	3	2.5	0.35	1.7	0.9
32317BJ2	85	180	63.5	391	560	62	2800	4000	7.50	SGD	85	135	60	49	4	3	52	102	99	138	166	169	7	14.5	3	2.5	0.54	1.1	0.6
32318J2	90	190	67.5	457	610	67	2600	4000	8.40	2GD	90	133	64	53	4	3	44	109	105	157	176	177	7	14.5	3	2.5	0.35	1.7	0.9
32319J2	95	200	71.5	501	670	72	2400	3400	11.0	2GD	95	141	67	55	4	3	47	115	110	166	186	186	8	16.5	3	2.5	0.35	1.7	0.9
32320J2	100	215	77.5	572	780	83	2200	3000	12.5	2GD	100	151	73	60	4	3	51	123	115	177	201	200	8	17.5	3	2.5	0.35	1.7	0.9
32321J2	105	225	81.5	605	815	85	2000	3000	14.5	2GD	105	158	77	63	4	3	53	129	120	185	211	209	9	18.5	3	2.5	0.35	1.7	0.9
32322	110	240	84.5	627	830	86.5	1900	2800	17.0	2GD	110	168	80	65	4	3	55	137	125	198	226	222	9	19.5	3	2.5	0.35	1.7	0.9
32324J2	120	260	90.5	792	1120	110	1800	2600	21.5	2GD	120	181	86	69	4	3	60	148	135	213	245	239	9	21.5	3	2.5	0.35	1.7	0.9